

F

E

D

C

B

A

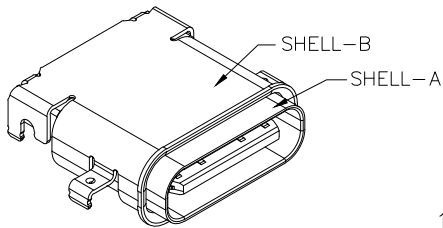

RoHS Compliant

ZONE	SYMBOL	REVISION	APPROVAL	DATE
		ADD ASSEMBLY O-RING DIAGRAM	H.Q.ZHOU	5-1-2024

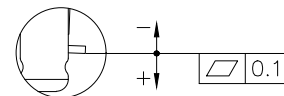
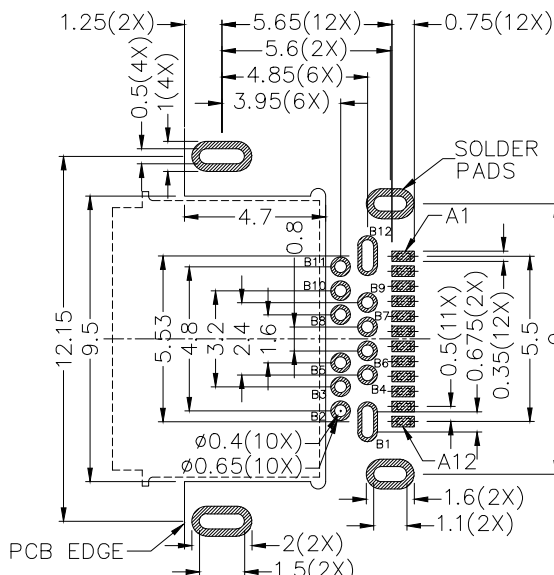
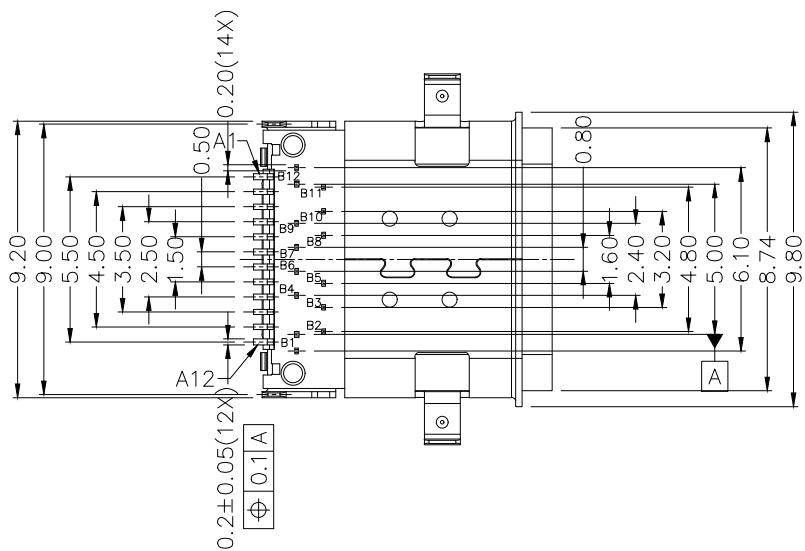
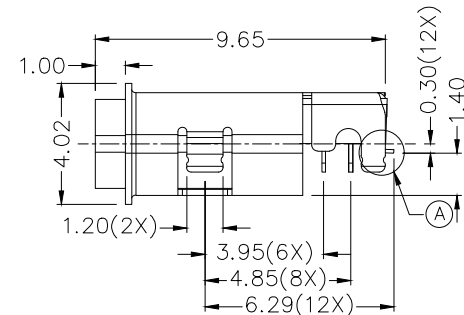
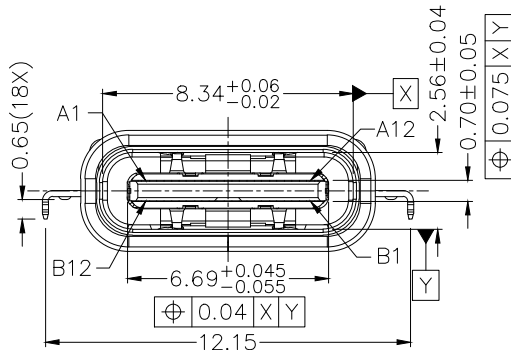
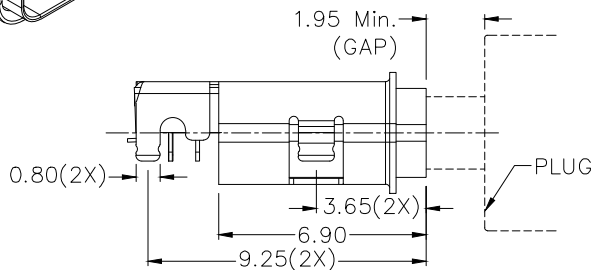

A DETAIL COPLANARITY

RECOMMENDED PCB LAYOUT
TOLERANCE: ±0.05
(TOP VIEW)

PIN ASSIGNMENT (FRONT VIEW)

PIN NO.	A1	A2	A3	A4	A5	A6	A7	A8	A9	A10	A11	A12
	GND	TX1+	TX1-	Vbus	CC1	D+	D-	SBU1	Vbus	RX2-	RX2+	GND
PIN NO.	B12	B11	B10	B9	B8	B7	B6	B5	B4	B3	B2	B1
	GND	RX1+	RX1-	Vbus	SBU2	D-	D+	CC2	Vbus	TX2-	TX2+	GND

DESCRIPTION	MATERIAL	PLATING
TERMINAL-A	COPPER ALLOY	NICKEL PLATED ON ALL AREA, Au 15u" MIN ON CONTACT AREA, Au 1u" MIN ON SOLDER AREA
TERMINAL-B	COPPER ALLOY	NICKEL PLATED ON ALL AREA, Au 15u" MIN ON CONTACT AREA, Au 1u" MIN ON SOLDER AREA
SHELL-A	STAINLESS STEEL	NICKEL(Ni)
SHELL-B	STAINLESS STEEL	NICKEL(Ni)
INNER GROUND COVER SHELL	STAINLESS STEEL	NICKEL(Ni)
MIDDLE PLATE	STAINLESS STEEL	
INSULATOR	HIGH TEMP. PLASTIC	COLOR:BLACK



LINKPLEX TECHNOLOGY LIMITED

PART NAME WATERPROOF USB 3.2 TYPE-C (24 PIN) CONNECTOR
PART NO. LWP-C106D

TOLERANCE UNLESS 0.0±0.3
0.00±0.2
OTHERWISE SPECIFIED: 0.000±0.1

UNIT: mm



DESIGN	H.L.TAN	DATE	23-10-2020	SCALE	4:1
DRAWING	J.Q.ZHOU	DATE	5-1-2024	MATERIAL	
CHECK	T.Y.LI	DATE	5-1-2024	DWG. NO.	TZ\WPC106D-A/2.0
APPROVAL	H.Q.ZHOU	DATE	5-1-2024	SHEET	1/2

F

E

D

C

B

A

F

E

D

C

B

A



RoHS Compliant

ZONE	SYMBOL	REVISION	APPROVAL	DATE

1

1

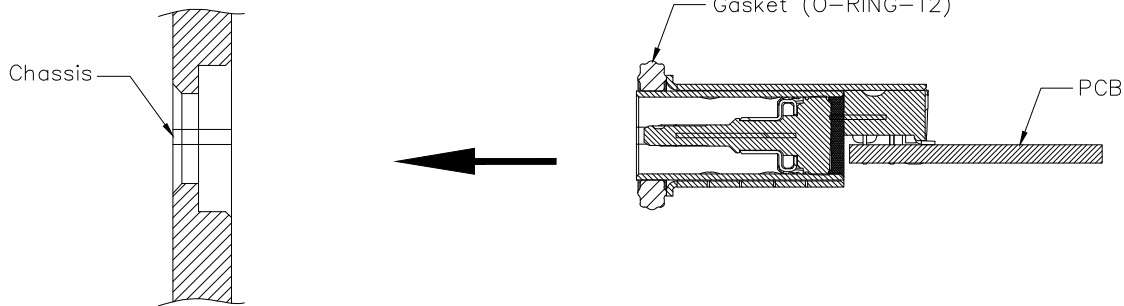

Assembly method

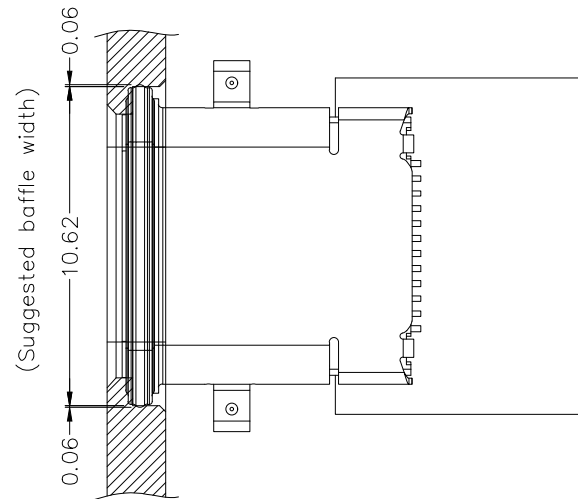

2

2

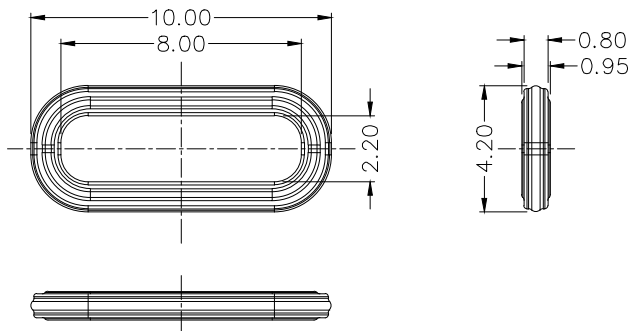

* Recommended Waterproof Gasket
Gasket Part No.: O-RING-12

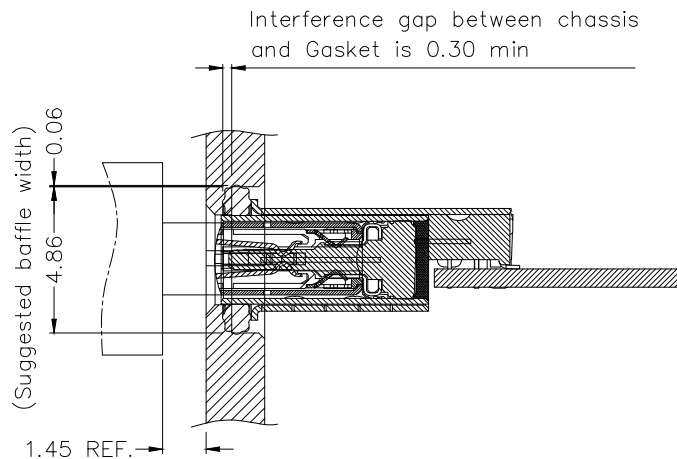

After assembling on chassis

3

3

4

4

LINKPLEX TECHNOLOGY LIMITED

DESIGN	H.L.TAN	DATE	23-10-2020	SCALE	4:1
DRAWING	J.Q.ZHOU	DATE	5-1-2024	MATERIAL	
CHECK	T.Y.LI	DATE	5-1-2024	DWG. NO.	TZ\WPC106D-A/2.0
APPROVAL	H.Q.ZHOU	DATE	5-1-2024	SHEET	2/2

PART NAME	WATERPROOF USB 3.2 TYPE-C (24 PIN) CONNECTOR	TOLERANCE UNLESS	0.0±0.3 0.00±0.2	UNIT:	
PART NO.	LWP-C106D	OTHERWISE SPECIFIED:	0.000±0.1		

F

E

D

C

B

A